

Phonak Audéo™ I

User Guide

Phonak Audéo I-R
Phonak Audéo I-R Trial



This user guide is valid for:

Wireless hearing aids



Phonak Audéo I90-R
Phonak Audéo I70-R
Phonak Audéo I50-R
Phonak Audéo I30-R
Phonak Audéo I-R Trial

Simple to follow instructions videos and further support can be found online:

<https://www.phonak.com/en-int/support.html>

Note that instructions for the activity functions can be found in the myPhonak User Guide.



Your hearing aid details

- ① If no box is checked and you do not know the model of your hearing aid or charging accessories, please ask your hearing care professional.
- ① The hearing aids described in this user guide contain a built-in and non-removable rechargeable lithium-ion battery.
- ① Please also read safety information regarding handling rechargeable hearing aids (chapter 24).

Hearing aid models

- Audéo I-R (I90/I70/I50/I30)
- Audéo I-R Trial

Earpieces

- Dome
- SlimTip
- cShell

For further information on compatible accessories please consult your hearing care professional.

The full list can be found online at the following link:
<https://www.phonak.com/audéo-i-professionals>



Contents

Your hearing aids have been developed by Phonak – a world leader in hearing solutions based in Zurich, Switzerland.

These premium products are the result of decades of research and expertise and are designed with your well-being in mind. We thank you for making such a great choice and wish you many years of listening pleasure.

Please read the user guide carefully to make sure that you understand and get the best out of your device. Training is not required for handling of this device. A hearing care professional will help set up this device according to your individual preferences during the fitting consultation. For more information regarding features, benefits, set up, use, maintenance or repairs of your hearing aid and accessories, please contact your hearing care professional or the manufacturer representative. Additional information can be found in the datasheet of your product.

Phonak - life is on
www.phonak.com

Your hearing aid

- | | |
|------------------------------|----|
| 1. Quick guide | 7 |
| 2. Parts of the hearing aid | 9 |
| 3. Charging the hearing aids | 10 |

Using the hearing aid

- | | |
|----------------------------------------|----|
| 4. Left and right hearing aid markings | 14 |
| 5. Putting on the hearing aid | 15 |
| 6. Removing the hearing aid | 16 |
| 7. Multi-function button | 17 |
| 8. On/Off | 18 |
| 9. Tap Control | 19 |
| 10. Connectivity overview | 20 |
| 11. myPhonak app overview | 21 |
| 12. Roger™ overview | 22 |
| 13. Initial pairing | 23 |
| 14. Phone calls | 25 |
| 15. Flight mode | 30 |
| 16. Rebooting your hearing aid | 33 |

Further information

17. Environmental conditions	34
18. Care and maintenance	36
19. Exchanging the earwax protection	39
20. Service and warranty	50
21. Compliance information	52
22. Information and description of symbols	60
23. Troubleshooting	66
24. Important safety information	72

1. Quick guide

Charging your hearing aids

i Before using your hearing aid for the first time, it is recommended to charge it for 3 hours.

After placing your hearing aid in the charger, the indicator light on the hearing aid will show the charging state of the battery until it is fully charged. When fully charged, the indicator light will be constantly on, i.e. solid green.



Left & right hearing aid markings

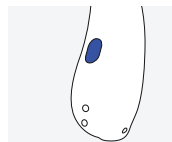

Blue marking for
left hearing aid.

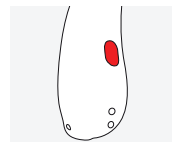

Red marking for
right hearing aid.

Multi-function button with indicator light

The button has several functions, the primary function is as an on/off switch.

Together with your hearing care professional, you can decide if it also allows for volume control, program change and other functionalities. This is indicated in your individual instructions.

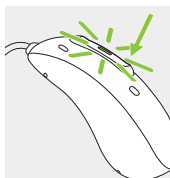

Phone calls: If paired with a Bluetooth® enabled phone, a short press will accept and a long press will reject an incoming call.

On/Off: Firmly press the lower part of the button for 3 seconds until the indicator light blinks.

On: indicator light is solid green

Off: indicator light is solid red

Enter flight mode: When device is off, press the lower part of the button for 7 seconds until the solid orange light appears. Then release the button.

Tap Control

If paired with a Bluetooth® enabled device, multiple functions can be accessed using Tap Control, please refer to chapter 9. This is also indicated in your individual instructions. To use Tap Control tap the top of your ear twice.

2. Parts of the hearing aid

The following pictures show the hearing aid model described in this user guide. You can identify your personal models by:

- checking "Your hearing aid details" on page 3.
- comparing your earpieces and hearing aid with the following models.

Possible earpieces

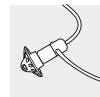

Dome



SlimTip



Sensor cShell

Audéo I-R

Audéo I-R Trial

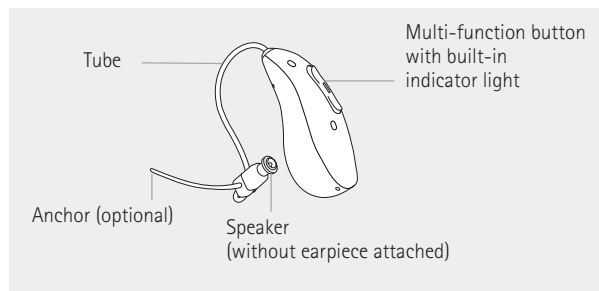

3. Charging the hearing aids

- ① Before using your hearing aid for the first time, it is recommended to charge it for 3 hours..
- ① Low power: You will hear two beeps when the hearing aid battery is low. You will have approximately 60 minutes before you have to charge the hearing aid, after this time the hearing aid automatically shuts down (this can vary, depending on the hearing aid settings).
- ① The hearing aid contains a built-in and non-removable rechargeable lithium-ion battery.
- ① The hearing aid must be dry before charging.
- ① Please ensure to charge the hearing aid within operating temperature range:
+5° to +40° Celsius (41° to 104° Fahrenheit)

3.1 Using the compatible charger

For more details about the charger please refer to your charger user guide.

1.

Insert the hearing aid into the charging slots and the earpieces in the large cavity.

Make sure the left and right hearing aid markings match the left (blue), right (red) indicators next to the charging slots. The hearing aids will automatically switch off once inserted into the charger connected to the power supply.

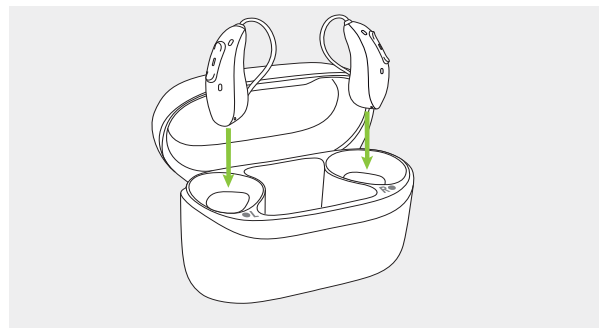





2.

The indicator light on the hearing aid will show the charging state of the battery until the hearing aid is fully charged. When fully charged the indicator light will remain on, i.e. solid green.

The charging process will automatically stop when the batteries are fully charged, so the hearing aids can be safely left in the charger. It can take up to 3 hours to charge the hearing aids. The charger lid can be closed while charging.

Charging times

Indicator light	Charging state	Approx. charging times
	0 – 10%	
	11 – 80%	30 min (20%) 60 min (40%) 120 min (70%)
	81 – 99%	
	100%	3 h

3.

Remove the hearing aids from the charging slots by simply lifting them out of the charger.

The hearing aid can be set to switch on automatically when removed from the charger. In this case the indicator light will start blinking. The solid green light indicates the hearing aid is ready for use.

For information on how to switch off your charger, please consult your charger User Guide.

 Do not hold the tubes to remove the hearing aids from the charger as this can damage the tubes.

4. Left and right hearing aid markings

There is a red or blue marking on the back of the hearing aid and on the speaker. This will tell you if it is a left or a right hearing aid.

Blue marking
for left hearing aid.

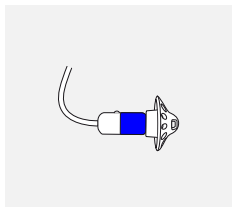
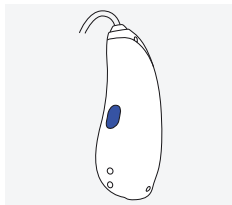

Red marking
for right hearing aid.

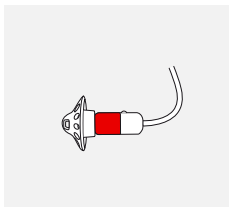
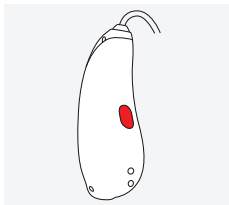

5. Putting on the hearing aid

1.
Place the hearing aid behind your ear.

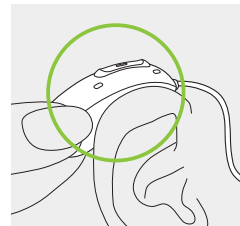

2.
Insert the earpiece into your ear canal.

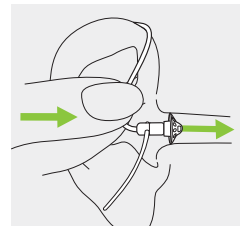

3.
If there is an anchor attached to the earpiece, tuck it into the bowl of your ear to secure your hearing aid.

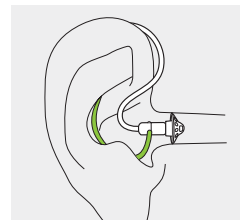

6. Removing the hearing aid

Pull on the bend of the tube and remove the hearing aid from behind the ear.

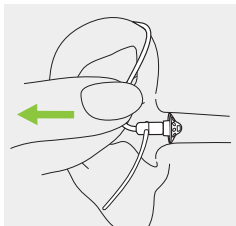

7. Multi-function button

The button has several functions. The primary function is as an on/off switch. Together with your hearing care professional, you can decide if it also allows for volume control, program change and other functionalities.

This is indicated in your individual "Hearing aid instructions". Please ask your hearing care professional for a printout.

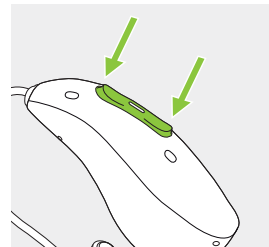

If the hearing aid is paired with a Bluetooth® enabled phone, a short press on the upper or the lower part of the button will accept an incoming call and a long press will reject an incoming call – refer to chapter 14.

8. On/Off

Switch on hearing aid

The hearing aid is configured to switch on automatically when removed from the charger. If this function is not configured, firmly press and hold the lower part of the button for 3 seconds until the indicator light blinks. Wait until the solid green light indicates the hearing aid is ready.

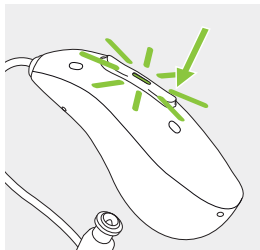

Switch off hearing aid

Press and hold the lower part of button for 3 seconds until the solid red light indicates the hearing aid is switching off.

	Blinking green	Hearing aid is switching on
	Solid red for 2 seconds	Hearing aid is switching off

① When you switch on the hearing aid you might hear a start-up melody.

9. Tap Control

Tap Control is only available for models I90 and I70. If paired with a Bluetooth® enabled device, multiple functions can be accessed using Tap Control e.g. accept/end phone call, pause/resume streaming, start/stop voice assistant. This is indicated in your individual "Hearing aid instructions".

To use Tap Control tap the top of your ear twice.



10. Connectivity overview

The illustration below shows the connectivity options available for your hearing aid.

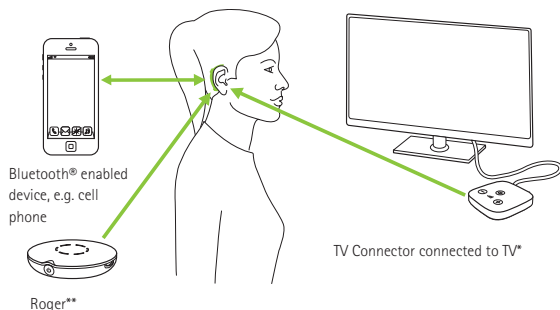

* The TV Connector can be connected to any audio source such as a TV, PC or hi-fi system.

** Roger wireless microphones can be connected to your hearing aids as well.

11. myPhonak app overview

Please find the Instruction for Use on <https://www.phonak.com/myphonak> or scan the code



Install the myPhonak app



12. Roger™ overview

Experience the hearing performance of Roger™

Roger™ is designed to improve hearing in situations with background noise or distance to the speaker. The microphone picks up the voice of the speaker and wirelessly transmits it directly to Roger receivers* in your hearing aids. This enables you to fully participate in group conversations even in very noisy environments such as restaurants, meetings at work and school activities.

To learn more about the Roger technology and microphones, please visit the webpage <https://www.phonak.com/roger-solutions> or scan the QR code.



* RogerDirect™ requires the installation of Roger receivers into the Phonak hearing aids by a hearing care professional.

13. Initial pairing

13.1 Initial pairing to a Bluetooth® enabled device

① It is only necessary to perform the pairing procedure once with each device featuring Bluetooth wireless technology. After the initial pairing, your hearing aids will connect automatically to the device. Initial pairing can take up to 2 minutes.

1.

On your device (e.g. a phone), ensure that Bluetooth® wireless technology is enabled and search for Bluetooth® enabled devices in the connectivity setting menu.

2.

Switch on both hearing aids. You now have 3 minutes to pair your hearing aids with your device.

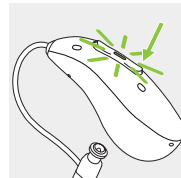

3.
Your device shows a list of Bluetooth® enabled devices. Select the hearing aid from the list to simultaneously pair both hearing aids. A beep confirms successful pairing.

- ❶ For more information about pairing instructions for Bluetooth wireless technology, specific to some of the most popular phone manufacturers, go to: <https://www.phonak.com/en-int/support>
- ❷ If several entries for your hearing aid are shown on the list of Bluetooth enabled devices, select the one without the prefix "LE_".

13.2 Connecting to the device

After your hearing aids have been paired to your device, they will automatically connect again when switched on.

- ❶ The connection will be maintained as long as the device remains ON and within range.
- ❷ Your hearing aid can be connected to up to two devices and paired to up to eight devices.

14. Phone calls

Your hearing aids connect directly with Bluetooth® enabled phones. When paired and connected to your phone, you will hear notifications, incoming call notification and the caller's voice directly in your hearing aids. Phone calls are "hands free", this means your voice is picked up by the hearing aid's microphones and transmitted back to the phone.

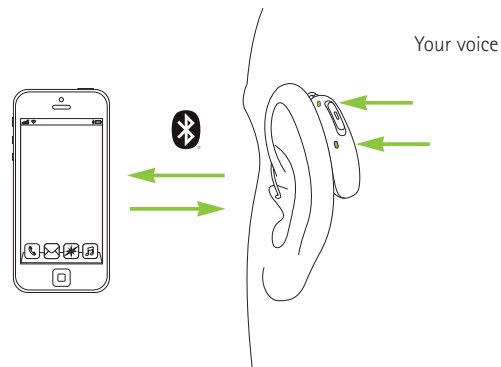

14.1 Making a call

Enter the phone number and press the dial button. You will hear the dialing tone through your hearing aids. Your voice is picked up by the hearing aid microphones and transmitted to the phone.

14.2 Accepting a call

When receiving a call, an incoming-call notification will be heard in the hearing aids (e.g. ring tone or voice notification).

The call can be accepted by tapping the top of your ear twice, a short press on the upper or lower part of the multi-function button on the hearing aid (less than 2 seconds) or directly on your phone.

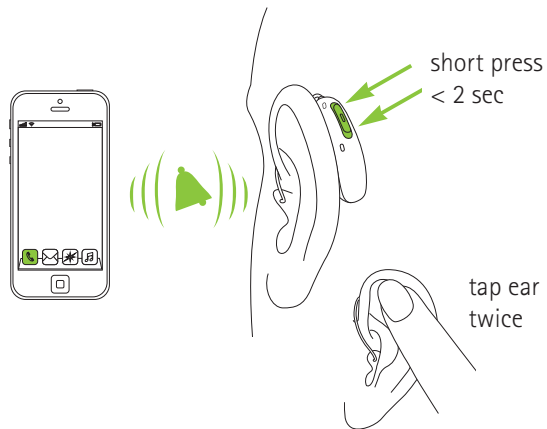

14.3 Ending a call

A call can be ended by a long press on the upper or lower part of the multi-function button on the hearing aid (more than 2 seconds) or directly on your phone. The phone call can also be ended by tapping the top of your ear twice.

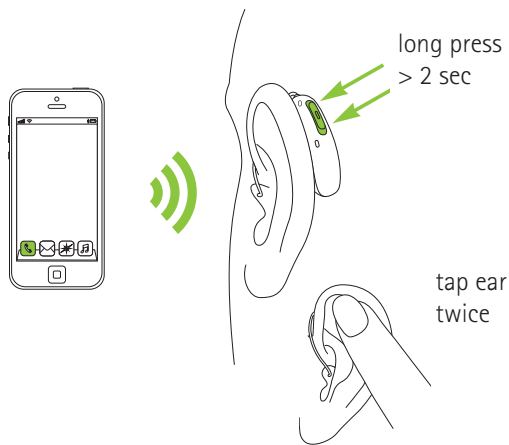

14.4 Rejecting a call

An incoming call can be rejected by a long press on the upper or lower part of the multi-function button on the hearing aid (more than 2 seconds) or directly on your phone.

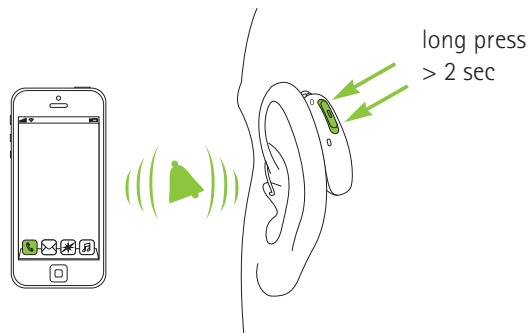





15. Flight mode

Your hearing aids operate between 2.4 GHz–2.48 GHz frequency range. When flying some operators require all devices to be switched into flight mode. Entering flight mode will not disable normal hearing aid functionality, only the Bluetooth connectivity functions.

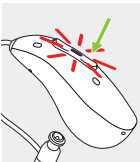
15.1 Enter flight mode

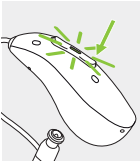
To disable the wireless function and enter flight mode in each hearing aid:

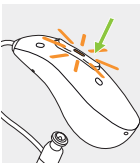
1.		If the hearing aid is turned off, proceed to Step 2. If the hearing aid is on, turn it off by pressing and holding the lower part of the button for 3 seconds, until the indicator light turns solid red for 3 seconds, signifying that the hearing aid is switching off.	
2.		Press and hold the lower part of the button. The green indicator light blinks when the hearing aid starts up.	
3.		Keep pressing the button for 7 seconds, until the indicator light is solid orange, then release the button. The solid orange light indicates the hearing aid is in flight mode.	

In flight mode, your hearing aid cannot connect directly to your phone.

15.2 Exit flight mode

To enable the wireless function and exit flight mode in each hearing aid:

Switch the hearing aid off and then on again - refer to chapter 8.



16. Rebooting your hearing aid

Use this technique if your hearing aid is in an error state. This will not remove or delete any program or settings.

Press the lower part of the multi-function button for at least 15 seconds. It does not matter if the hearing aid is switched on or off before you start pressing the button. After 15 seconds, the HI will restart with the indicator light blinking green.

17. Environmental conditions

The product is designed such that it functions without problems or restrictions if used as intended, unless otherwise noted in these user guides.

Please ensure to use, charge, transport and store the hearing aids according to the following conditions:

	Charging and operating	Transport	Storage
Temperature	+5 to +40 °C (41 to 104 °F)	-20 to +60 °C (-4 to 140 °F)	-20 to +60 °C (-4 to 140 °F)
Humidity (non condensing)	0% to 90%	0% to 93%	0% to 93%
Atmospheric pressure	500 hPa to 1060 hPa	500 hPa to 1060 hPa	500 hPa to 1060 hPa

Prolonged storage at temperatures lower than +10 °C and higher than +30 °C may negatively affect the battery performance of the product.

If the device has been subject to storage and transport conditions outside of the recommended use conditions, bring the device back into recommended use conditions before starting the device.

These hearing aids are classified as IP68. This means that they are water and dust resistant and designed to withstand daily life situations.

Please ensure to charge the hearing aids regularly during long-term storage.

18. Care and maintenance

Expected Service Life:

The hearing aids and the compatible charger have the expected service life of five years. The devices are expected to remain safe for use for this duration.

Commercial service period:

Routine and diligent care of your hearing aids and charger will contribute to the outstanding performance for the duration of the expected service life of your devices. Sonova AG will provide a minimum of a five year repair service period after the respective hearing aid, charger and essential components have been phased out of the product portfolio.

Please use the following specifications as a guideline. For further information regarding product safety, see chapter 24.

General information

Before using hair spray or applying cosmetics, you should remove your hearing aid from your ear, because these products may damage it.

Your hearing aids are resistant to water, sweat and dust under the following conditions:

- After exposure to water, sweat or dust, the hearing aid is cleaned and dried.
- The hearing aid is used and maintained as described in this user guide.

 Always make sure that the hearing aids and charger are dry and clean.

Daily

Hearing aid: Inspect the earpiece for earwax and moisture deposit and clean the surfaces with a lint-free cloth. Never use cleaning agents such as household detergents, soap, etc. for cleaning your hearing aid. It is not recommended to rinse with water. If you need to clean your hearing aid intensively, ask your hearing care professional for advice and information on filters or drying methods.

Weekly

Hearing aid: Clean the earpiece with a soft, damp cloth or with a special cleaning cloth for hearing aids. For more in-depth maintenance instructions, please see your hearing care professional. Clean the charging contacts on the hearing aid with a soft, damp cloth.

19. Exchanging the earwax protection

Your hearing aid is equipped with an earwax protection to protect the speaker from earwax damage.

Please check the earwax protector regularly and exchange it if it looks dirty or if the hearing aid volume or sound quality is reduced. The earwax protection should be replaced every four weeks on a regular receiver, and every two weeks on the ActiveVent™ receiver. Your hearing care professional can advise you on individual replacement cycles.

19.1.1 Removing the earpiece from the speaker

1. Remove the earpiece from the speaker by holding the speaker in one hand and the earpiece in the other.

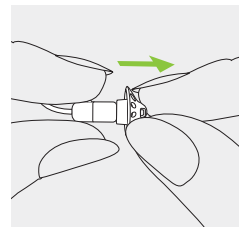

2. Gently pull off the earpiece to remove.

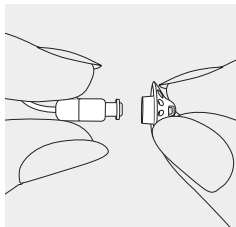

3. Clean the speaker with a lint-free cloth.

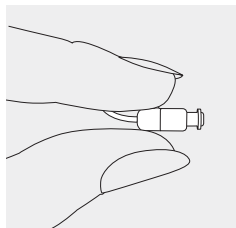

19.1.2 Exchanging the earwax protection with CeruStop

1. Insert the removal side of the exchange tool into the used earwax protector. The shaft of the holder should touch the rim of the earwax protector.

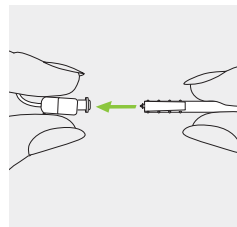

2. Carefully pull and remove the earwax protector straight out of the speaker. Please do not twist the earwax protector when removing.

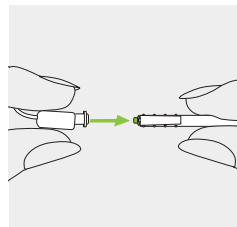

3.

To insert the new earwax protector, gently push the insertion side of the exchange tool straight into the hole of the speaker until the outer ring is perfectly aligned.

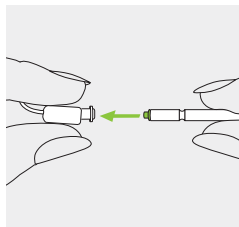

4.

Pull the tool straight out. The new earwax protector will remain in place. Now attach your earpiece to the speaker.

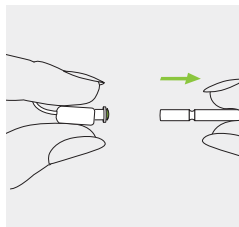

19.1.3 Attaching the earpiece to the speaker

1.

Hold the speaker in one hand and the earpiece in the other.

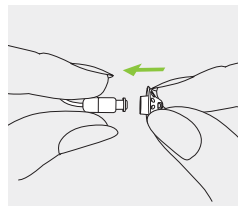

2.

Slide the earpiece over the speaker sound outlet.

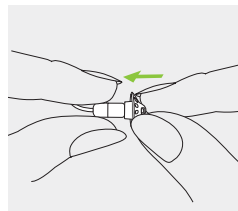

3.

The speaker and the earpiece should fit perfectly together.

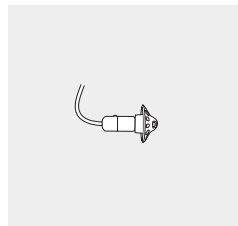

19.2 ActiveVent™ receiver with SlimTip

19.2.1 Parts Explanation

1. Wax filter dispenser

a) rotating disk

b) new filter

c) dispensing slot for used filters

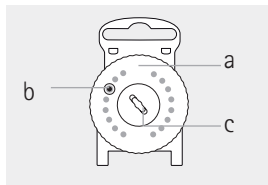

2. Changing tool

a) screw end for removing used filter

b) forked end for inserting new filter

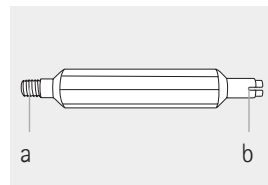

19.2.2 Removing the used wax filter (HF3 Filter)

1.

Hold the earpiece firmly and secure the rear of the speaker with your finger.

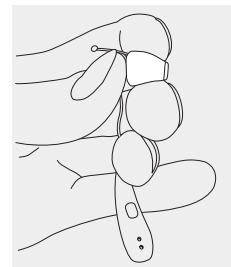

2.

Insert the screw end of the HF3 changing tool into the speaker of the hearing aid.

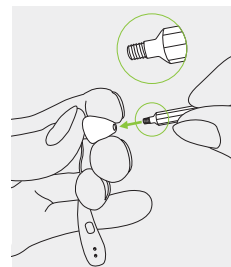

3.

Rotate the changing tool clock-wise until some resistance is felt.
Pull the changing tool out of the speaker with the used wax filter attached to the end.

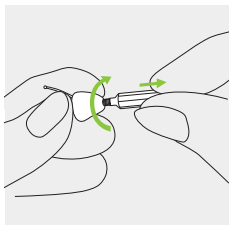

4.

Insert the used wax filter into the dispensing slot in the middle of the wax filter dispenser.

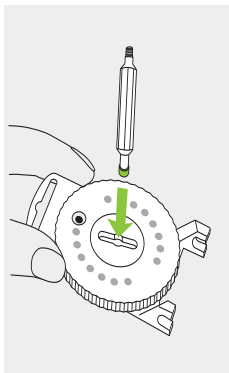

5.

Slide the changing tool to either side of the dispensing slot. Lift the changing tool up, leaving the used wax filter in dispensing slot.

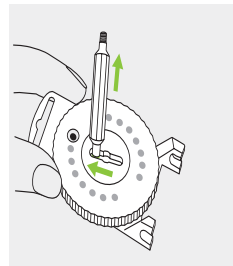

19.2.3 Inserting a new wax filter

1.

After removing the used wax filter from the speaker of the hearing aid, brush away any remaining debris.
Rotate the ridged disk of the wax filter dispenser until a new wax filter is visible in the window of the disk.

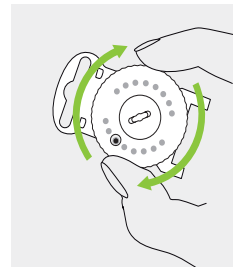

2.

Now use the opposite end of the changing tool (i.e. forked end) to pick up a new wax filter.

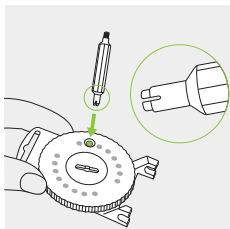

3.

Insert the forked end of the changing tool down and pull up

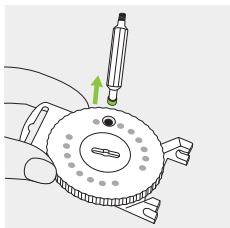

4.

Insert the new wax filter into the speaker of the hearing aid. Make sure to secure the rear of speaker with your finger.

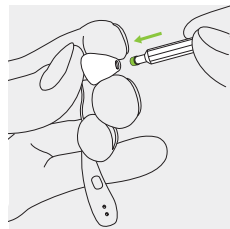

5.

Once the new filter is securely placed in the speaker, lift the changing tool away tilted in a slight angle. Reattach the changing tool to the wax filter dispenser

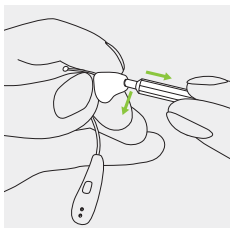

20. Service and warranty

Local warranty

Please ask the hearing care professional where you purchased your hearing aids about the terms of the local warranty.

International warranty

Sonova AG offers a one year limited international warranty, valid from the date of purchase. This limited warranty covers manufacturing and material defects in the hearing aid and charger respectively, but not accessories such as tubes, earpieces, external receivers. The warranty only comes into force if a proof of purchase is shown.

The international warranty does not affect any legal rights that you might have under applicable national legislation governing sale of consumer goods.

Warranty limitation

This warranty does not cover damage from improper handling or care, exposure to chemicals or undue stress. Damage caused by third parties or non-authorized service centers renders the warranty null and void. This warranty does not include any services performed by a hearing care professional in their office.

Serial numbers

Hearing aid left side: _____

Hearing aid right side: _____

Charger: _____

Date of purchase: _____

Authorized hearing care professional
(stamp/signature):

21. Compliance information

Europe:

Declaration of Conformity for the hearing aid

Hereby Sonova AG declares that this product meets the requirements of the Medical Device Regulation (EU) 2017/745 as well as the Radio Equipment Directive 2014/53/EU.

The full text of the EU Declaration of Conformity can be obtained from the manufacturer or the local Phonak representative whose address can be taken from the list on <https://www.phonak.com/en-int/certificates> (Phonak worldwide locations).

Australia/New Zealand:



R-NZ

Indicates a device's compliance with applicable Radio Spectrum Management's (RSM) and Australian Communications and Media Authority (ACMA) regulatory arrangements for the legal sale in New Zealand and Australia.

The compliance label R-NZ is for radio products supplied in the New Zealand market under conformity level A1.

The wireless models listed on page 2 are certified under:

Phonak Audéo I-R (90/70/50/30)

Phonak Audéo I-R Trial

USA	FCC ID: KWC-IRF
-----	-----------------

Canada	IC: 2262A-IRF
--------	---------------

Notice 1:

This device complies with Part 15 of the FCC Rules and with RSS-210 of Industry Canada. Operation is subject to the following two conditions:

- 1) this device may not cause harmful interference, and
- 2) this device must accept any interference received, including interference that may cause undesired operation.

Notice 2:

Changes or modifications made to this device not expressly approved by Sonova AG may void the FCC authorization to operate this device.

Notice 3:

This device has been tested and found to comply with the limits for a Class B digital device, pursuant to Part 15 of the FCC Rules and ICES-003 of Industry Canada. These limits are designed to provide reasonable protection against harmful interference in a residential installation.

This device generates, uses and can radiate radio frequency energy and, if not installed and used in accordance with the instructions, may cause harmful interference to radio communications. However, there is no guarantee that interference will not occur in a particular installation. If this device does cause harmful interference to radio or television reception, which can be determined by turning the equipment off and on, the user is encouraged to try to correct the interference by one or more of the following measures:

- Reorient or relocate the receiving antenna.
- Increase the separation between the device and receiver.
- Connect the device into an outlet on a circuit different from that to which the receiver is connected.
- Consult the dealer or an experienced radio/TV technician for help.

Radio information of your wireless hearing aid

Antenna type	Resonant loop antenna
Operation frequency	2.4 GHz – 2.48 GHz
Modulation	GFSK, Pi/4-DQPSK, 8-DPSK, GMSK
Radiated power	< 2.5 mW

Bluetooth®

Range	~2 m
Bluetooth	5.3 Dual-Mode
Profiles supported	HFP (Hands-free profile), A2DP

Emissions Test Compliance Electromagnetic environment guidance

RF emissions CISPR 11	Group 2 Class B	The medical device uses RF energy only for its internal function. Therefore, its RF emission are very low and are not likely to cause any interferences in nearby electronic equipment
Harmonic emissions	Complies	
Voltage fluctuations / flicker emissions	Complies	

Electromagnetic emissions

Manufacturer's Declaration: The hearing aids are intended for use in the electromagnetic environments listed below. The user should assure that they are used in such environments.

Emission Test Compliance Electromagnetic environment guidance

RF emissions CISPR 11	Group 1	The hearing aids generate or use RF energy only for their internal functioning. Therefore, the RF emissions are very low and are not likely to cause any interference to nearby electronic equipment.
RF emissions CISPR 11	Class B	The hearing aids are suitable for use in domestic establishment and in establishment directly connected to a low voltage power supply network which supplies buildings used for domestic purposes.

Electromagnetic immunity

Immunity Test	IEC60601-1-2 Test Level	Compliance Level
Electrostatic Discharge (ESD) IEC 61000-4-2	+/- 8 kV contact +/- 2 kV, +/- 4 kV, +/- 8 kV, +/- 15 kV air	+/- 8 kV contact +/- 2 kV, +/- 4 kV, +/- 8 kV, +/- 15 kV air
Radiated RF Electromagnetic Field Immunity Test IEC 61000-4-3	10 V/m 80 MHz – 2.7 GHz 80% AM at 1 kHz	10 V/m 80 MHz – 2.7 GHz 80% AM at 1 kHz
Proximity Magnetic Field IEC 61000-4-3	9 V/m; 710, 745, 780 MHz; Pulse modulation 18 Hz 9 V/m; 5240, 5500, 5785 MHz; Pulse modulation 217 Hz 27 V/m; 385 MHz; Pulse modulation 18 Hz 28 V/m; 450 MHz FM +/- 5 kHz deviation; 1 kHz sine	9 V/m; 710, 745, 780 MHz; Pulse modulation 18 Hz 9 V/m; 5240, 5500, 5785 MHz; Pulse modulation 217 Hz 27 V/m; 385 MHz; Pulse modulation 18 Hz 28 V/m; 450 MHz FM +/- 5 kHz deviation; 1 kHz sine

Immunity Test	IEC60601-1-2 Test Level	Compliance Level
Proximity Magnetic Field IEC 61000-4-3	28 V/m; 810, 870, 930 MHz; Pulse modulation 18 Hz 28 V/m; 1720, 1845, 1970, 2450 MHz; Pulse modulation 217 Hz	28 V/m; 810, 870, 930 MHz; Pulse modulation 18 Hz 28 V/m; 1720, 1845, 1970, 2450 MHz; Pulse modulation 217 Hz
Rated power frequency magnetic fields IEC 61000-4-8	30 A/m 50 Hz or 60 Hz	30 A/m 50 Hz or 60 Hz

22. Information and description of symbols



With the CE symbol, Sonova AG confirms that this product – including accessories – meets the requirements of the Medical Devices Regulation (EU) 2017/745 as well as the Radio Equipment Directive 2014/53/EU. The numbers after the CE symbol correspond to the code of certified institutions that were consulted under the above-mentioned regulation and directive.



This symbol indicates that the products described in these user instructions adhere to the requirements for an applied part of Type B of EN 60601-1. The surface of the hearing aid is specified as an applied part of Type B.



Indicates the medical device manufacturer, as defined in Medical Device Regulation (EU) 2017/745.



Indicates the date when the medical device was manufactured



Indicates the Authorized representative in the European Community. The EC REP is also the importer to the European Union.



This symbol indicates that it is important for the user to read and take into account the relevant information in these user guides.



This symbol indicates that it is important for the user to pay attention to the relevant warning notices in these user guides.



This symbol indicates that it is important for the user to pay attention to the relevant warning notices related to batteries in these user guides



Important information for handling and product safety.



This symbol confers that the electromagnetic interference from the device is under limits approved by the US Federal Communications Commission.



Indicates a device's compliance with applicable Radio Spectrum Management's (RSM) and Australian Communications and Media Authority (ACMA) regulatory arrangements for the legal sale in New Zealand and Australia



The Bluetooth® word mark and logos are registered trademarks owned by Bluetooth SIG, Inc. and any use of such marks by Sonova AG is under license. Other trademarks and trade names are those of their respective owners.



Japanese mark for certified radio equipment.



Indicates the manufacturer's serial number so that a specific medical device can be identified.



Indicates the manufacturer's catalogue number so that the medical device can be identified.



Indicates that the device is a medical device.



An indication that electronic instructions for use are available.

IP68 Ingress Protection Rating. IP68 rating indicates that the hearing aid is water and dust resistant. It survived continuous immersion in 1 meter of fresh water for 60 minutes and 8 hours in a dust chamber as per the IEC60529 standard.



Indicates the temperature limits to which the medical device can be safely exposed.



Indicates the range of humidity to which the medical device can be safely exposed.



Indicates the range of atmospheric pressure to which the medical device can be safely exposed.



During transportation keep dry.



This symbol indicates a device that is not safe to use in magnetic resonance (MR) environment (e.g. during an MRI scan).



The symbol with the crossed-out garbage bin is to make you aware that this hearing aid may not be thrown away as normal household waste. Please dispose of old or unused hearing aids, at waste disposal sites intended for electronic waste, or give your hearing aid to your hearing care professional for disposal. Proper disposal protects the environment and health

Symbols applicable to the European power supply only



Power supply with double isolation.



Device designed for indoor use only.



Safety isolating transformer, short circuit proof.

23. Troubleshooting

Cause	What to do
Problem: Hearing aid not functioning	
Speaker/earpiece blocked	Clean speaker opening/earpiece
Hearing aid switched off	Press lower part of multi-function button for 3 seconds (chapter 7)
Battery fully discharged	Charge hearing aid (chapter 3)
Hearing aid in error state	Reboot the hearing aid (chapter 16)

Problem: Hearing aid whistles	
Hearing aid not inserted correctly into ear	Insert hearing aid correctly (chapter 6)
Cerumen in ear canal	Contact your ENT/GP or hearing care professional

Please check <https://www.phonak.com/en-int/support.html> for further information

Cause	What to do
Problem: Hearing aid too loud	
Volume too loud	Decrease volume if volume control available (chapter 7)

Problem: Hearing aid not loud enough or distorted	
Volume too low	Increase volume if volume control available (chapter 7)
Low battery	Charge hearing aid (chapter 3)
Speaker/earpiece blocked	Clean speaker opening/earpiece
Hearing has changed	Contact your hearing care professional

Problem: Hearing aid plays two beeps	
Indication for low battery	Charge hearing aid (chapter 3)

Problem: Hearing aid will not switch on	
Battery fully discharged	Charge hearing aid (chapter 3)

Cause	What to do
Problem: Indicator light on hearing aid does not light up when hearing aid placed in charging slots	
Hearing aid not inserted correctly into charger	Insert hearing aid correctly into charger (chapter 3)
Hearing aid battery fully discharged	Wait three hours after placing hearing aid in charger, regardless of LED behavior

Problem: Indicator light on hearing aid is solid red while hearing aid is in the charger	
Hearing aid is out of its operating temperature range	Warm hearing aid up or cool it down. Operating temperature range is +5° to +40° Celsius (+41° to +104° Fahrenheit)
Faulty battery	Contact your hearing care professional

Please check <https://www.phonak.com/en-int/support.html> for further information

Cause	What to do
Problem: Indicator light on hearing aid switches off when hearing aid is removed from charger	
"Auto On" feature is disabled	Switch on the hearing aid (chapter 7)

Problem: Indicator light on hearing aid remains solid green after removal from charger	
Indicator light on hearing aid was red when hearing aid was placed into the charger	Reboot the hearing aid (chapter 16)

Problem: Battery does not last the whole day	
Shortened battery life	Contact your hearing care professional. A battery replacement may be required.

Cause	What to do
Problem: Phone call function does not work	
Hearing aid is in flight mode	Switch hearing aid off and then on again (chapter 15.2)
Hearing aid not paired to the phone	Pair hearing aid to the phone (chapter 14)

Problem: Charging does not start (but indicator light around the charger USB port lights up green when the charger is connected to the power outlet.)	
Charger not connected to power source.	Connect charger to external power supply.
Hearing aid not inserted correctly into charger	Insert hearing aid correctly into charger (chapter 3.1)

Please check <https://www.phonak.com/en-int/support.html> for further information

Cause	What to do
Problem: Hearing aid with ActiveVent™ receiver is not working properly	
Vent in wrong position (e.g. closed)	Reboot by switching hearing aid off and on again
Wax, other	Clean the speaker opening and / or change the wax filter (chapter 19.2). Contact your hearing care professional.

Problem: ActiveVent™ receiver feels loose in earpiece or has separated completely from earpiece	
Speaker dislodged from earpiece (i.e during exchange of earwax protection)	Push the speaker back into the earpiece. If the speaker is still loose contact your hearing care professional.

❗ If the problem persists, contact your hearing care professional for assistance.

24. Important safety information

Please read the relevant safety information and limitations-of-use information on the following pages before using your hearing aid.

Intended use

The hearing aid is intended to amplify and transmit sound to the ear and thereby compensate for impaired hearing.

The Tinnitus software feature is intended for use by people with tinnitus who also desire amplification. It provides supplementary noise stimulation which can help defocus the user's attention from their tinnitus.

Intended patient population:

This device is intended for patients with unilateral and bilateral, mild to profound hearing loss from 8 years of age. The Tinnitus software feature is intended for patients with chronic tinnitus from 18 years of age.

Intended user:

Hearing aids: Intended for people with hearing loss using a hearing aid and their caregivers. A hearing care professional is responsible for adjusting the hearing aid.

Indications:

Clinical indications for the use of hearing aids and Tinnitus software feature are:

Presence of hearing loss

- Uni- or bilateral
- Conductive, sensorineural or mixed
- Mild to profound

Presence of a chronic tinnitus (> 3 months, after occurrence) in addition to the presence of a hearing loss (only applicable for devices which provide the Tinnitus feature).

Contraindications:

Clinical contra-indications for the use of hearing aids and Tinnitus software feature are:

- Acute tinnitus (< three months after it occurs)
- Deformity of the ear (i.e. closed ear canal; absence of the auricle)
- Neural hearing loss (i.e. retro-cochlear pathologies such as absent / non-viable auditory nerve)

The primary criteria for the referral of a patient for a medical or other specialist opinion and / or treatment are as follows:

- Visible congenital or traumatic deformity of the ear;
- History of active drainage from the ear in the previous 90 days;
- History of sudden or rapidly progressive hearing loss in one or both ears within the previous 90 days;
- Acute or chronic dizziness;
- Audiometric air-bone gap equal to or greater than 15 dB at 500 Hz, 1000 Hz and 2000 Hz;
- Visible evidence of significant cerumen accumulation or a foreign body in the ear canal;
- Pain or discomfort in the ear;
- Abnormal appearance of the eardrum and ear canal such as:

- Inflammation of the external auditory canal
- Perforated eardrum
- Other abnormalities which the hearing care professional believes are of medical concern

Special care should be exercised in selecting and fitting a hearing aid whose maximum sound pressure level exceeds 132 decibels (dB) because there may be risk of impairing the remaining hearing of the hearing aid user. (This provision is required only for those hearing aids with a maximum sound pressure capability greater than 132 dB).

The hearing care professional may decide that referral is not appropriate or in the best interests of the patient when the following applies:

- When there is sufficient evidence that the condition has been fully investigated by a medical specialist and any possible treatment has been provided;
- The condition has not worsened or changed significantly since the previous investigation and / or treatment.
- If the patient has given their informed and competent decision not to accept advice to seek a medical opinion,

it is permissible to proceed to recommend appropriate hearing aid systems subject to the following considerations:

- The recommendation will not have any adverse effects on the patients health or general well being;
- The records confirm that all necessary considerations about the patient's best interests have been made

If legally required, the patient has signed a disclaimer to confirm that the referral advice has not been accepted and that it is an informed decision.

Clinical benefit:

Hearing aids: Improvement of speech understanding

Tinnitus feature: Tinnitus software feature provides supplementary noise stimulation which can help defocus the user's attention from their tinnitus.

Side effects:

Physiological side-effects of hearing aids like tinnitus, dizziness, wax build up, too much pressure, sweating or moisture, blisters, itching and/or rashes, plugged or fullness

and their consequences like headache and/ or ear pain, may be resolved or reduced by your hearing care professional.

Conventional hearing aids have the potential to expose patients to higher levels of sound exposure, which might result in threshold shifts in the frequency range affected by acoustic trauma.

The hearing aid is suitable for the home healthcare environment and due to their portability it may happen that it is used in professional healthcare facility environment like physician offices, dental offices etc.

A hearing aid will not restore normal hearing and will not prevent or improve a hearing impairment resulting from organic conditions. Infrequent use of a hearing aid does not permit a user to attain full benefit from it. The use of a hearing aid is only part of hearing habilitation and may need to be supplemented by auditory training and instruction in lipreading.

Feedback, poor sound quality, too loud or too soft sounds, inadequate fitting or problems when chewing or swallowing, can be resolved or improved during the



fine-tuning process at the fitting procedure by your hearing care professional.

Any serious incident that has occurred in relation to the hearing aid, should be reported to the manufacturer representative and the competent authority of the state of residence. The serious incident is described as any incident that directly or indirectly led, might have led or might lead to any of the following:

- a) the death of a patient, user or other person
- b) the temporary or permanent serious deterioration of a patient's, user's or other person's state of health
- c) a serious public health threat

To report an unexpected operation or event, please contact the manufacturer or a representative.

24.1 Warnings

-  The majority of hearing aid users have a hearing loss for which a deterioration in hearing is not to be expected with regular use of a hearing aid in everyday situations. Only a small group of hearing aid wearers with hearing loss, may be at risk of deterioration in hearing after a long period of use.
-  The hearing aids (specially programmed for each hearing loss) must only be used by the intended person. They should not be used by any other person as they could damage hearing.
-  Special medical or dental examination including radiation described below, may adversely affect the correct functioning of your hearing aids. Remove and keep them outside the examination room/area before undergoing:
 - Medical or dental examination with X-ray (also CT scan)
 - Medical examinations with MRI/NMRI scans, generating magnetic fieldsHearing aids don't need to be removed when passing security gates (airports etc.). If X-ray is used at all, it will be in very low doses, and will not affect the hearing aids.

 Patients implanted with magnetic externally programmable CSF shunt valves may have a risk of experiencing an unintended change in their valve setting when exposed to strong magnetic fields.

The receiver (loudspeaker) of hearing aids, the Lyric SoundLync, the Lyric programming wand and the MiniControl contain static magnets. Keep a distance of 2 inches (approx. 5 cm) or more between the magnets and the site of the implanted shunt valve.

 Hearing programs in the directional microphone mode reduce background noises. Please be aware that warning signals or noises coming from behind, e. g. cars, are partially or entirely suppressed.

 The hearing aids have to be dry before charging. Otherwise the charging reliability cannot be guaranteed.

 Hearing aids and their parts should be kept out of reach of children and anyone who might swallow, choke on or otherwise cause injury to themselves with them. If swallowed consult a physician or hospital immediately as the hearing aid

or its parts can be poisonous. In the event of choking immediately administer treatment or contact emergency services.

 The usage of this device by children and individuals with cognitive impairment should be supervised at all times to ensure their safety

 **WARNING:** This device uses a lithium button/coin battery. These batteries are hazardous and can cause severe or fatal injuries in 2 hours or less if they are swallowed or placed inside any part of the body, whether the battery is used or new! Keep out of the reach of children, individuals with cognitive impairment, or pets. If you suspect that a battery was swallowed or placed inside any part of the body, immediately consult your physician without any delay!

 Protect your hearing aid from heat and sunlight (never leave near a window or in the car). Never use a microwave or other heating devices to dry your hearing aid (due to risk of fire or explosion). Ask your hearing care professional about suitable drying methods.

 Do not remove receiver cables from the hearing instruments. If removal or exchange is required it is recommended to contact the hearing care professional.

 Changes or modifications to the hearing aid that were not explicitly approved by Sonova AG are not permitted. Such changes may damage your ear or the hearing aid.

 Do not use the device in explosive areas (mines or industrial areas with danger of explosions, oxygen-rich environments or areas where flammable anesthetics are handled). The device is not ATEX certified.

 Hearing aids should not be fitted with domes / wax protection systems when used by clients with perforated eardrums, inflamed ear canals or otherwise exposed middle ear cavities. In these cases, we recommend the use of a classic earmold. In the unlikely case that any part of this product should remain in the ear canal, it is strongly recommended to see a physician for safe removal.

 Use of this equipment adjacent to or stacked with other equipment should be avoided because it could result in improper operation. If such use is necessary, this equipment and the other equipment should be observed to verify that they are operating normally.

 Titanium shells of custom hearing aids and earpieces can contain small quantities of acrylates from adhesives. People who are sensitive to such substances may potentially experience an allergic skin reaction. Please stop using the device immediately if such a reaction occurs and check with your hearing care professional or physician.

 Only use the device according to chapter 17 "Environmental conditions" page 34. Using the device otherwise may heat the hearing aid up to temperatures, which in the worst-case can lead to skin burns.

 Make sure that you always completely dry your hearing aid after use. Store the hearing aid in a safe, dry and clean place.

- ⚠ Do not place these rechargeable devices in your checked-in luggage when traveling by plane as they contain lithium-ion batteries. The devices should be placed in your carry-on/hand luggage.
- ⚠ Ship the rechargeable devices according to local regulations as the devices contain lithium-ion batteries. For shipping, they are classified as dangerous goods. If in doubt ask the courier responsible for shipping how to ship the devices properly.
- ⚠ Avoid strong physical impacts to the ear when wearing a hearing aid with customized ear piece. The stability of a customized ear piece is designed for normal use. A strong physical impact to the ear (e.g. during sports) may cause the customized ear piece to break. This may lead to perforation of the ear canal or ear drum.
- ⚠ After mechanical stress or shock to the hearing aid, please ensure that the hearing aid shell is intact before placing it in the ear.

- ⚠ Portable RF communications equipment (including peripherals such as antenna cables and external antennas) should be used no closer than 30 cm (12 inches) to any part of the hearing aid or accessory, including cables specified by the manufacturer. Otherwise, degradation of the performance of this equipment could result.
- ⚠ Your device operates between 2.4 GHz and 2.48 GHz frequency range. When flying please check if flight operator requires devices to be switched into flight mode, see corresponding chapter regarding flight mode in this user guide.
- ⚠ The following is only applicable for persons with active implantable medical devices (i.e. pacemakers, defibrillators, etc.)
 - Keep the wireless device at least 15 cm (6 inches) away from the active implant. If you experience any interference do not use the wireless hearing aids and contact the manufacturer of the active implant. Please, note that the interference can also be caused by

powerlines, electrostatic discharge, airport metal detectors etc.

- Keep magnets (e.e battery handling tool, EasyPhone magnet, etc.) at least 15 cm (6 inches) away from the active implant.

 Do not use your hearing aid in areas where electronic equipment is prohibited.

 Do not drop your hearing aid! Dropping onto a hard surface can damage your hearing aid.

 In very rare cases, the dome can remain in your ear canal when removing the hearing tube from the ear. In the unlikely case that the dome does get stuck in your ear canal, it is strongly recommended to see a physician for safe removal.

 These hearing aids are water resistant. They are designed to withstand normal activities and occasional accidental exposure to extreme conditions.

Phonak hearing aids are not specifically designed for extended periods of water submersion on a continual basis, that is worn in activities such as swimming or

bathing. Always remove your hearing aid before these activities, as the hearing aid contains sensitive electronic parts.

 Use of accessories, transducers and cables other than those specified or provided by the manufacturer of this equipment could result in increased electromagnetic emissions or decreased electromagnetic immunity of this equipment and result in improper operation.

Warning to the Hearing Care Professionals

 Data sheet values were measured with a standardized custom shell. Please note deviation from these values may occur based on individualized acoustic coupling. Special care should be lead to MPO exceeding 132dB SPL.

24.2 Cautions



If you feel pain in or behind your ear, if it is inflamed or if skin irritation and accelerated accumulations of earwax occur, please check with your hearing care professional or physician.

24.3 Notes

- ① If you are not using your hearing aid for a long period of time, store it in a box with a drying capsule or in a well ventilated location. This allows moisture to evaporate from your hearing aid and prevents a potential impact on its performance.
- ① Never wash the microphone inputs. Doing so could cause it to lose its special acoustic features.
- ① The dome should be changed every three months or when it becomes stiff or brittle. This is to prevent the dome from detaching from the tube spout during insertion into or removal from the ear.
- ① Only use compatible devices for charging your hearing aids, otherwise the devices may be damaged.

Note to the Hearing Care Professionals

- ① Data sheet values were measured with a standard receiver. Please note deviation from these values may occur based on individualized custom shell coupling.

Your hearing care professional:



EC REP

Sonova Deutschland GmbH
Max-Eyth-Strasse 20
70736 Fellbach-Oeffingen
Germany

Australian Sponsor:

Sonova Australia Pty Ltd
12 Inglewood Place,
Norwest NSW 2153
Australia

029-1357-02/V1.00/2024-03/tm © 2024 Sonova AG All rights reserved



Manufacturer:

Sonova AG
Laubisrütistrasse 28
CH-8712 Stäfa
Switzerland
www.phonak.com



7 16133891731590

sonova
HEAR THE WORLD



CE
0459

